

KAY PARK REC. CORP.
 1301 Pine St.
 P.O. Box 477
 Janesville, IA 50647-0477

GENERAL SPECIFICATIONS:

MANUFACTURER'S QUALIFICATIONS

Manufacturer maintains all all times a quality control program as herein outlined so as to insure that all precast units are manufactured as specified under physical requirements. All precast units shall be manufactured by skilled workmen who have at least 10 years experience in similar work and supervised by foremen certified by the ACI (American Concrete Institute).

MANUFACTURING

All precast work shall be true to dimensions and have clean, accurate surfaces and be fully cured before casting. Reinforcing steel shall conform to ASTM A615 for rebar, and deformation shall conform to ASTM A618. All precast units shall have a minimum compressive strength of 4000 psi at 28 days of age when tested by means of 6 x 12 cylinder molds from the materials. There shall be a maximum of 4-6% air entrainment for all precast units according to ASTM standards.

REINFORCEMENT

All concrete products have reinforcement characteristics such as rebar or fiberglass.

MOLDS

The forms for the precast units shall be constructed of metal or fiberglass, and designed to withstand casting pressures without distortion. All anchors, inserts, bolts, etc., will be placed and secured in the forms as required for the attachment and handling of the units. These shall be cleaned or secured so as to hold them in position during fabrication.

PHYSICAL CHARACTERISTICS

All exposed surfaces are treated to remove the surface matrix and expose the aggregate produced by chemical treatment - no sand blasting. All precast units shall have water repellent sealer treatment applied in strict accordance with manufacturer's specifications. All tolerances shall be within 1/8" of specified dimensions, designed for structural analysis and calculation.

COLOR

Color to be uniform throughout as approved by owner or specifier, in accordance with manufacturer's recommendation.

MATERIALS

For final Cement: ASTM C 150 Type I or III.
 All aggregate to meet ASTM C 33 Specifications

REQUIRED MATERIALS FOR APPROVAL

- A. Shop drawings with dimensions, general construction component parts, anchoring details and installation instructions.
- B. Samples upon request for analysis.
- C. Complete data on manufacturer's specifications and technical information.

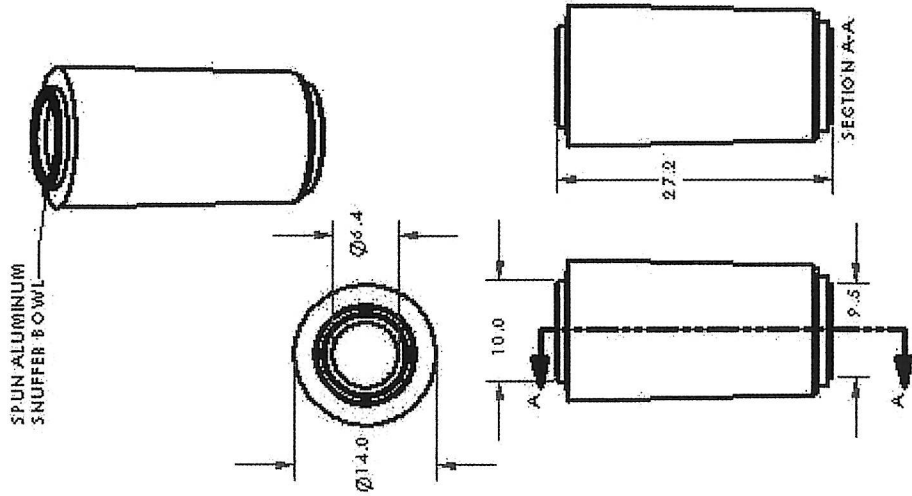

Model: CSR1324
Weight: 275 LBS.