

ITEM NO.	PART NUMBER	DESCRIPTION	QTY.
1	SQ-SA2 (Rev 1)	SQ SPIDER SUB ASSY	1
2	SQ-66	SQ. TOP ATTACHMENT ANGLE	4
3	RTRT-SA1	RTRT LEG ASSEMBLY	8
4	SQAW-2	TOP TABLE CLEAT	2
5	4SQW-7	SJ 2"x 10" SYP TREATED TOP PLANK	5
6	RHBOLT 0.375-16x2.25x1-N		20
7	Preferred Wide FW 0.375	FLAT WASHER 3/8" WIDE	24
8	Regular LW 0.375	LOCK WASHER 3/8"	24
9	HNUT 0.3750-16-D-N	HEX NUT 3/8"-16	24
10	HBOLT 0.3750-16x2.5x1-N	HEX HEAD BOLT 3/8"-16x 2 1/2"	3
11	HBOLT 0.3750-16x3x1-N	HEX HEAD BOLT 3/8"-16x 3"	1

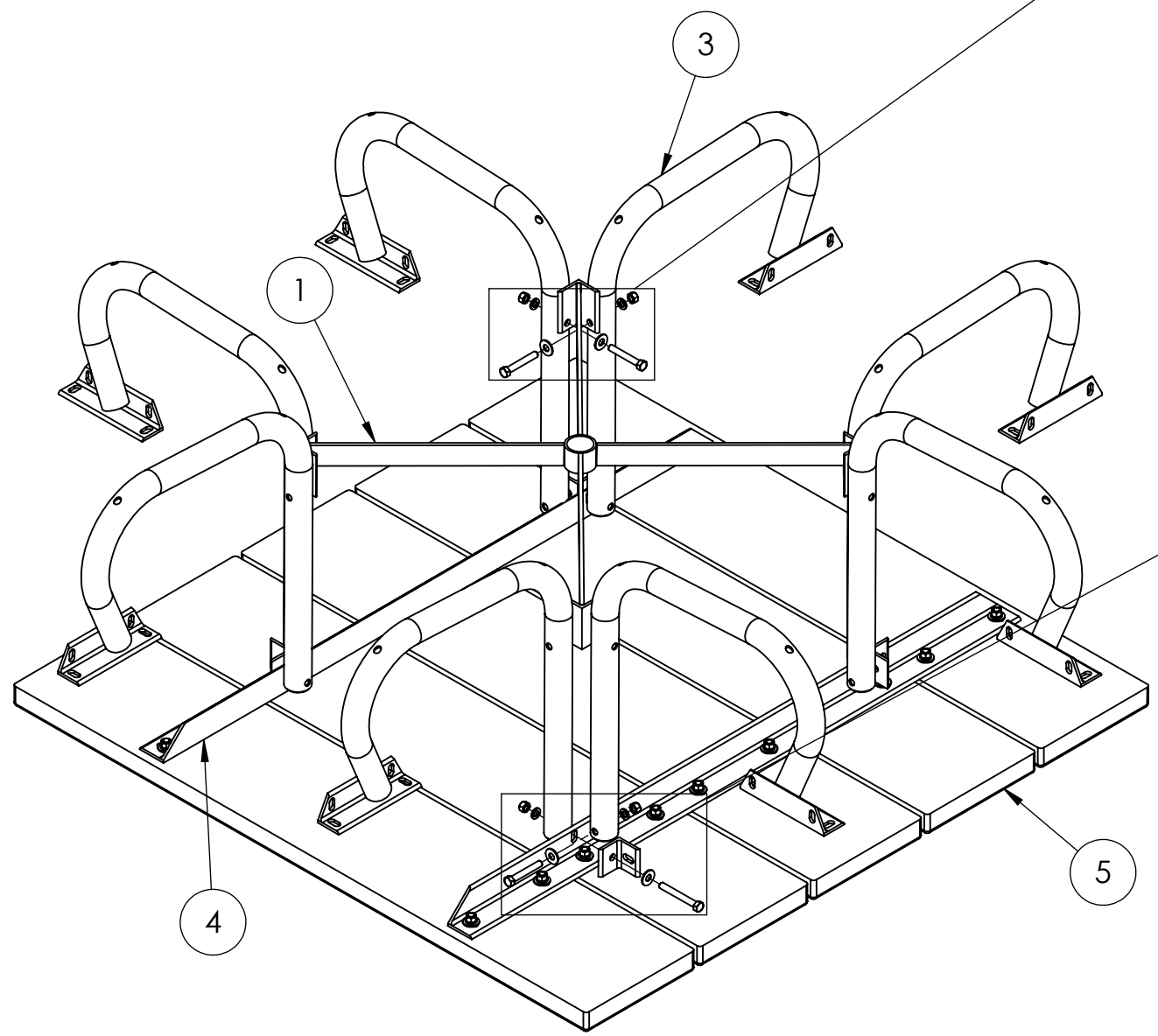
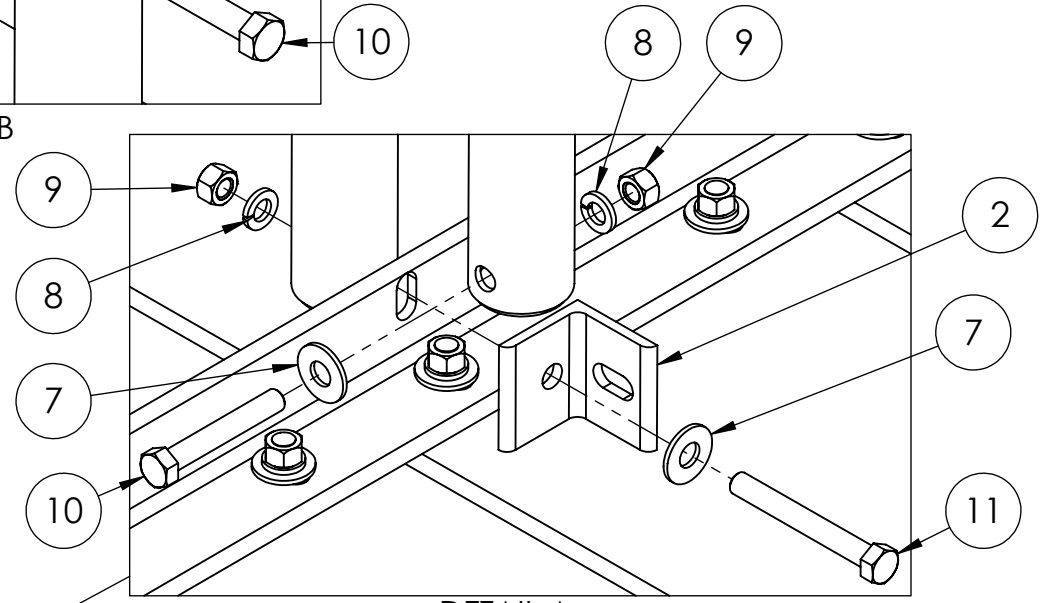
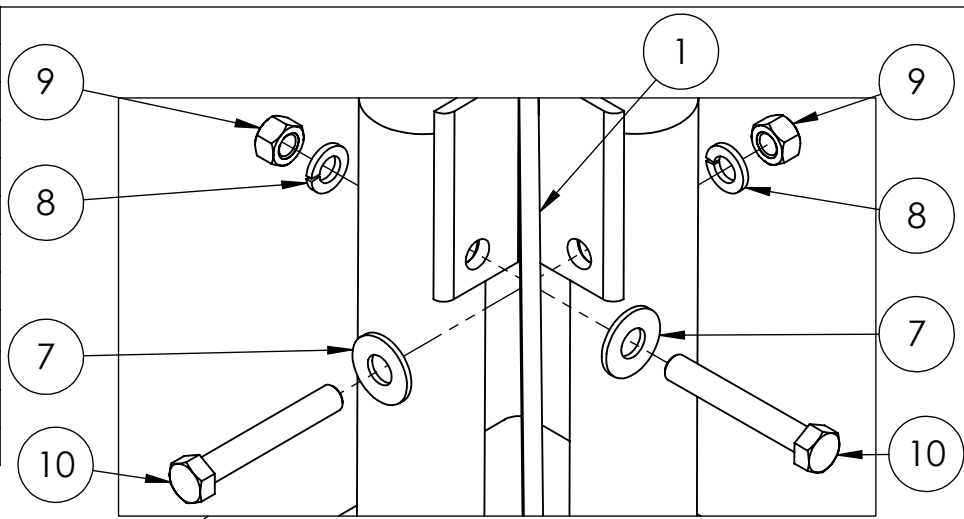

1. PLACE THE TABLE TOP USODE DOWN ON A RELATIVELY FLAT SURFACE SUCH AS CARD BOARD THE PRODUCT CAME IN
2. ASSEMBLE THE TABLE LEGS AS SHOWN IN **DETAIL A**, MAKE SURE THE 3" HEX HEAD BOLT IS USED WHERE THE SLOTS LINE UP. FINGER TIGHTEN THE BOLTS AND NUTS AT THIS TIME
3. NEXT ATTACH THE SPIDER CROSS BRACING TO THE BOTTOM PART OF THE LEGS START WITH ONE CORNER USING THE 3/8"-16X 2 1/2" HEX HEAD BOLTS, WASHERS, LOCK WASHERS, AND NUTS. GO TO THE OPPOSITE CORNER AND INSERT THAT HARDWARE. DO THE SAME PROCEDURE ON THE OTHER SETS OF LEGS. AS SHOWN IN **DETAIL B**
4. TIGHTEN THE NUTS AND BOLTS THAT ARE CLOSE TO THE TABLE TOP FIRST, MAKE SURE THE LEGS ARE STRAIGHT UP AND DOWN. TIGHTEN ALL NUTS AND BOLTS ON THE CROSS BRACING NEXT
5. TURN THE TABLE RIGHT SIDE UP TO ATTACH THE SEATS TO THE SEAT BRACKETS SEE SHEET 3 FOR DETAILS.

GENERAL NOTES	DIMENSIONS ARE IN INCHES TOLERANCES: LINEAR: ± 1/16 ANGULAR: ± 1°		SHEET SIZE <b>B</b>	SCALE 1:10	REV		<b>Kay Park Rec.</b>
	CONFIDENTIAL DRAWING. INFORMATION IS NOT TO BE COPIED OR DISCLOSED TO OTHERS WITHOUT CONSENT OF KAY INDUSTRIES. SPECIFICATIONS SUBJECT TO CHANGE WITHOUT NOTICE.	DRAWN BY	JNB	6/19/2017	DESC:	CHILD SIZE SJ TABLE W/ WOOD PLANKS	
		APPROVED			MATL:		
		LAST SAVED	johnb	6/19/2017	<b>PART NO: CS4SJCW</b>		
PATH TO PART OR ASSM - CS4SJCW	S:\CADDRWGS\Solidworks\Tables\Child Sized Tables\		Configuration - DEFAULT	6/19/2017 1:49:31 PM	SHEET 2 OF 3		

ITEM NO.	PART NUMBER	DESCRIPTION	QTY.
1	SQ-SA2 (Rev 1)	SQ SPIDER SUB ASSY	1
2	SQ-66	SQ. TOP ATTACHMENT ANGLE	4
3	3SQW-7	2"x 10" SYP TREATED SEAT PLANK	4
4	RTRT-SA1	RTRT LEG ASSEMBLY	8
5	SQAW-2	TOP TABLE CLEAT	2
6	4SQW-7	SJ 2"x 10" SYP TREATED TOP PLANK	5
7	RHBOLT 0.375-16x2.25x1-N		36
8	Preferred Wide FW 0.375	FLAT WASHER 3/8" WIDE	40
9	Regular LW 0.375	LOCK WASHER 3/8"	40
10	HNUT 0.3750-16-D-N	HEX NUT 3/8"-16	40
11	HBOLT 0.3750-16x2.5x1-N	HEX HEAD BOLT 3/8"-16x 2 1/2"	3
12	HBOLT 0.3750-16x3x1-N	HEX HEAD BOLT 3/8"-16x 3"	1

NOTE:  
ALL PLANKS ARE ATTACHED USING  
THE HARDWARE SHOWN IN  
DETAIL C

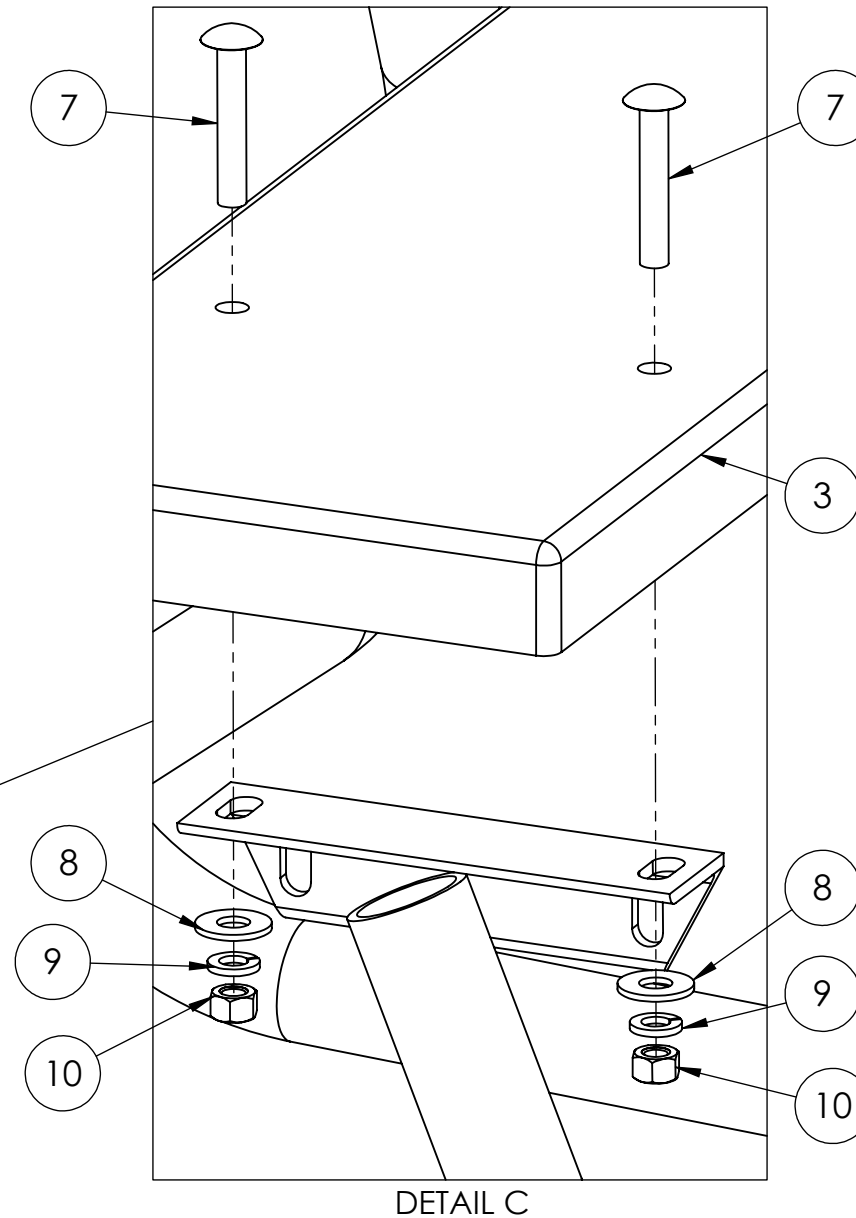
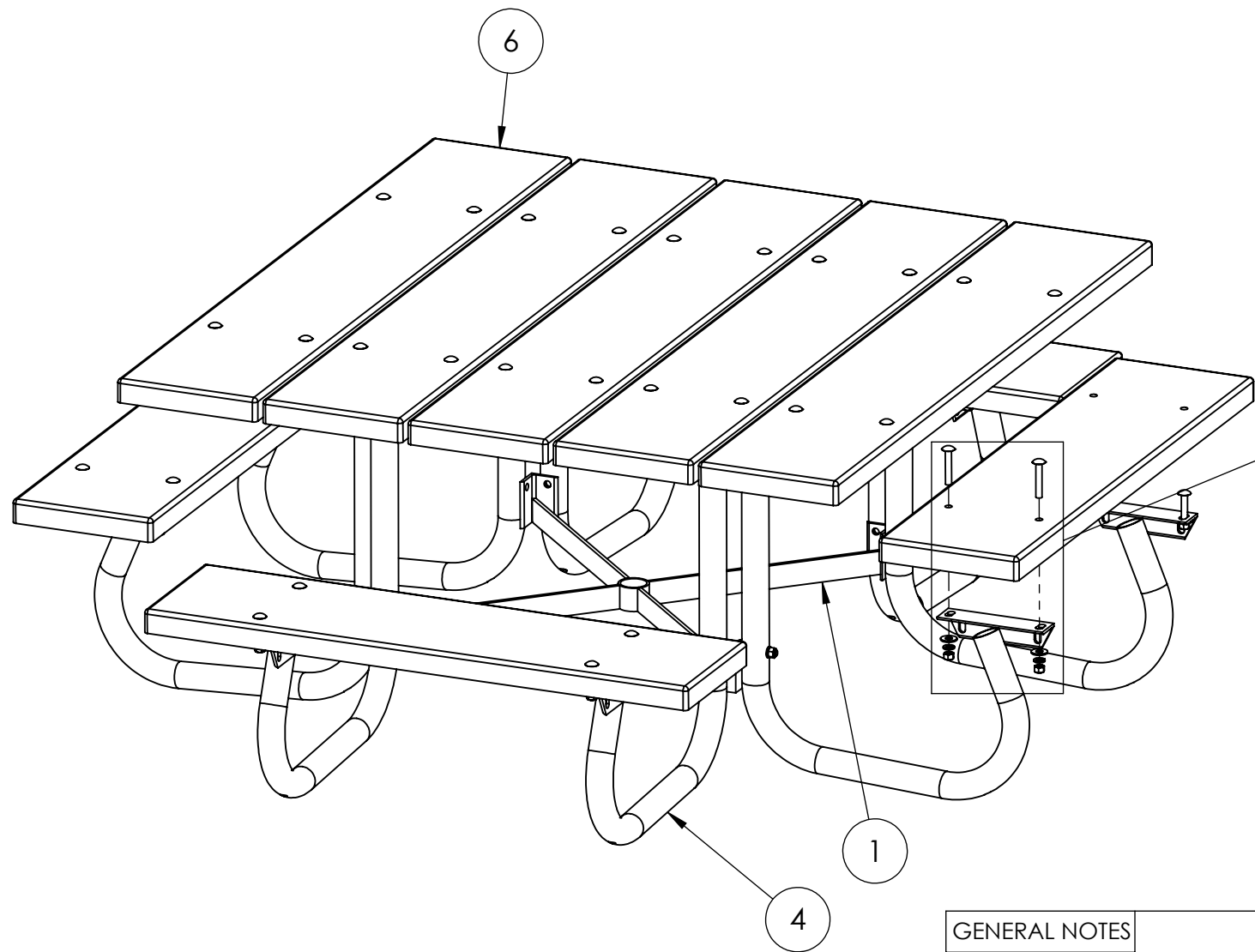

GENERAL NOTES

CONFIDENTIAL DRAWING.  
INFORMATION IS NOT TO BE COPIED OR  
DISCLOSED TO OTHERS WITHOUT  
CONSENT OF KAY INDUSTRIES.  
SPECIFICATIONS SUBJECT TO CHANGE  
WITHOUT NOTICE.

DIMENSIONS ARE IN INCHES  
TOLERANCES: LINEAR: ± 1/16  
ANGULAR: ± 1°

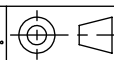

SHEET SIZE  
**B**

SCALE  
1:10

REV



**Kay Park Rec.**  
CHILD SIZE SJ TABLE W/ WOOD PLANKS

DRAWN BY

JNB

6/19/2017

DESC:

APPROVED

MATL:

LAST SAVED

johnb

6/19/2017

**PART NO: CS4SJCW**