

## END VIEWS

### DETAIL OF FIBERGLASS PLANK

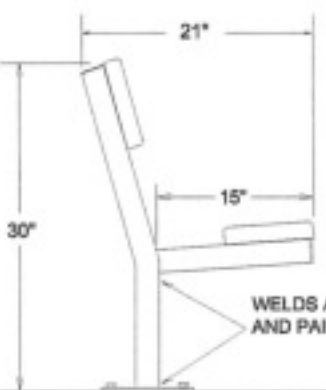

82PGF



82SGFSM

WELDS ARE CLEANED, COLD GALVANIZED AND PAINTED FOR A LONG LIFE

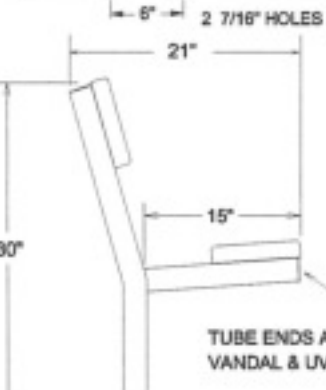

82SGF

TUBE ENDS ARE CAPPED WITH VANDAL & UV RESISTANT PLASTIC CAPS

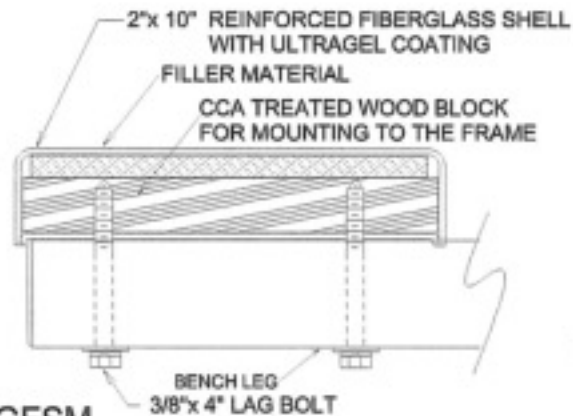

BENCH LEG  
3/8"x 4" LAG BOLT

## FRONT VIEW

82PGF

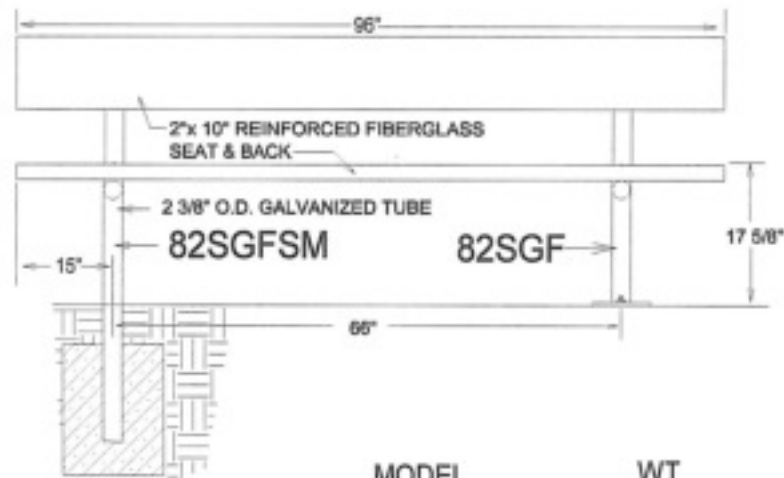
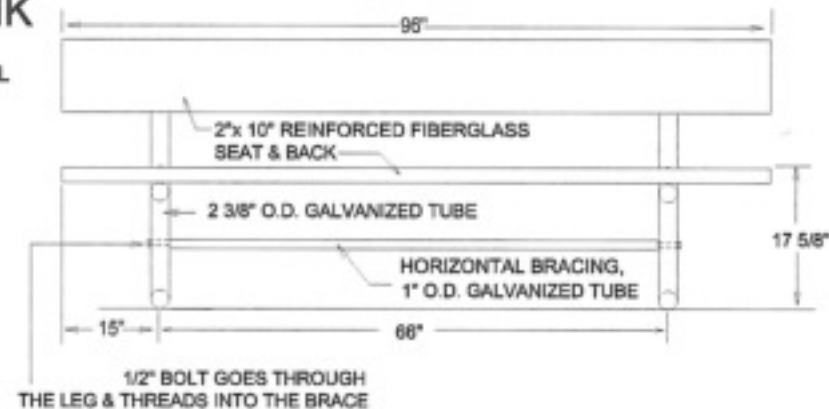

| MODEL   | WT.      |
|---------|----------|
| 82SGF   | 100 lbs. |
| 82SGFSM | 100 lbs. |
| 82PGF   | 105 lbs. |



## Kay Park Recreation

Making People Places, People Friendly Since 1954!  
Email us: [sales@kaypark.com](mailto:sales@kaypark.com) or Call us: (800)553-2476  
1301 Pine St. PO. Box 477 Janesville, IA 50647

NOTE: THE BURY DEPTH OF THE CONCRETE FOOTING IS ONLY A SUGGESTION THE LOCAL SOIL CONDITIONS SHOULD DETERMINE WHAT IS NECESSARY

THE ENDS OF THE LEGS ARE DEFORMED FOR PERMANENT ANCHORING IN CONCRETE

REV 10/00

FILE NO. 82PGF,82SGF,82SGFSM

## KAY PARK

|          |           |       |           |
|----------|-----------|-------|-----------|
| MODEL    | SEE ABOVE | WT.   | SEE ABOVE |
| DRAWN BY | JB        | DATE  | 10/13/00  |
|          |           | SCALE | NONE      |