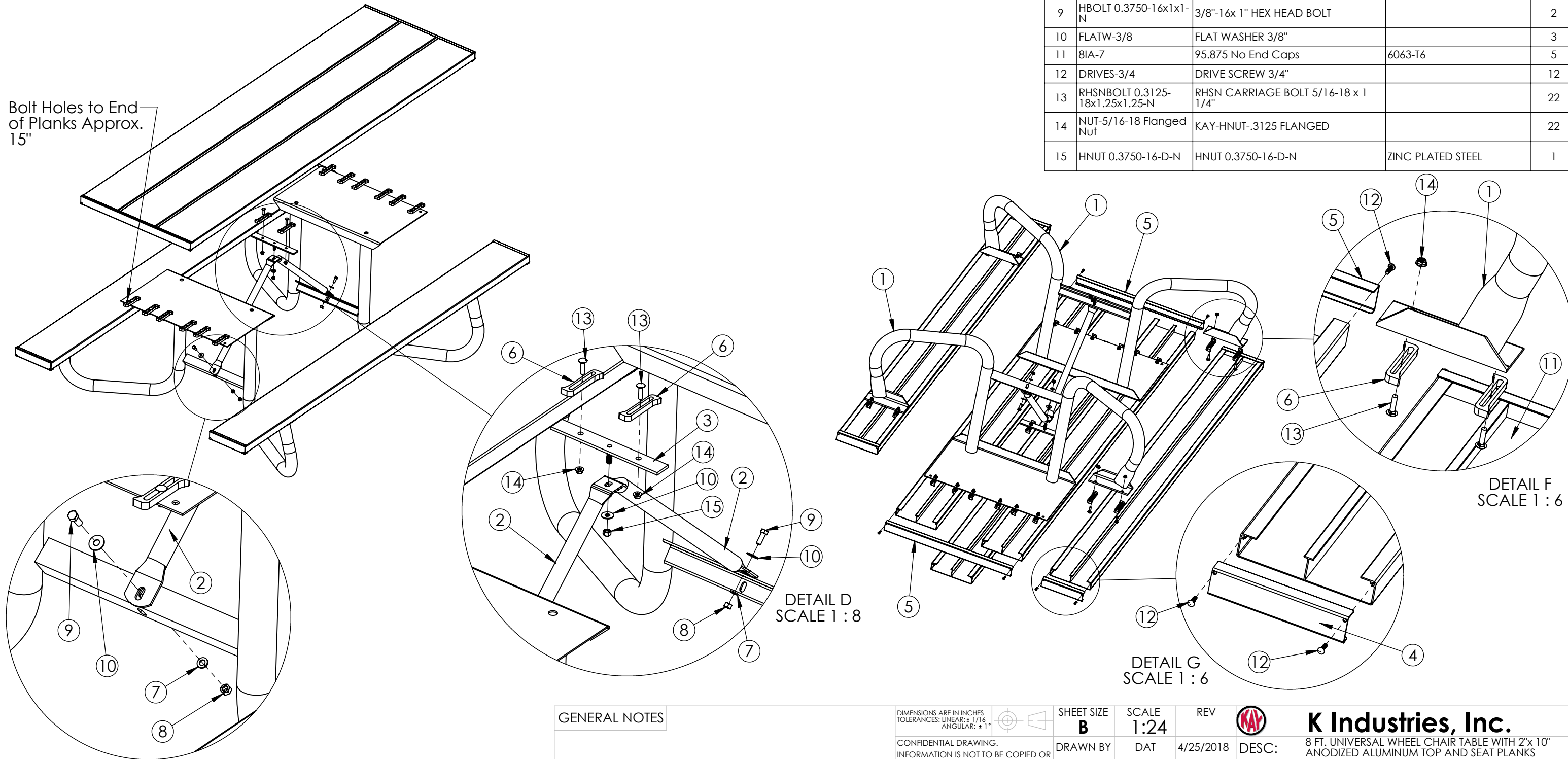

Table Frame Can Be Either Powder Coated To A Color Or Galvanized Per Customers Request

GENERAL NOTES UNIT WGT: 201 LBS.	<small>DIMENSIONS ARE IN INCHES TOLERANCES: LINEAR: \pm 1/16 ANGULAR: \pm 1°</small>		SHEET SIZE B	SCALE 1:24	REV		Kay Park Rec.	
	<small>CONFIDENTIAL DRAWING. INFORMATION IS NOT TO BE COPIED OR DISCLOSED TO OTHERS WITHOUT CONSENT OF KAY INDUSTRIES. SPECIFICATIONS SUBJECT TO CHANGE WITHOUT NOTICE.</small>	<small>DRAWN BY</small> DAT	<small>DATE</small> 4/25/2018	<small>DESC:</small> 8 FT. UNIVERSAL WHEEL CHAIR TABLE WITH 2"x 10" ANODIZED ALUMINUM TOP AND SEAT PLANKS	<small>MATL:</small>	<small>PART NO:</small> 8J2GA-UWC		
	<small>APPROVED</small>	<small>LAST SAVED</small> davet	<small>DATE</small> 3/19/2019					
	<small>PATH TO PART OR ASSM - S:\CADDRWGS\Solidworks\Tables\J2\New Handicap Table 062016\</small>	<small>Configuration - Default</small>	<small>3/19/2019 11:14:56</small>	<small>SHEET 1 OF 2</small>				

1. Place 3 Planks Side By Side, Upside Down and Measure to the Center of the Planks. Then Clip the Middle Brace Bar to the Middle Plank.
2. Set One of the Frames Upside Down with Bolt Holes Approximately 15" From the End of the Planks. Clip This Leg in Place Using (2) Plank Clips Per Plank.
3. Now Place the Diagonal Brace on the Brace Bar and Leg as Shown. Tighten Clips and Repeat this Procedure on the Other Table End. Make Sure the Leg Frames Face Inward Towards Each Other.
4. Turn the Table Right Side Up and Place (2) Seat Boards on the Seat Brackets, Attach Them with (2) Plank Clips On Each End.
5. Put the End Caps On After the Top and Seat Planks have Been Securely Fastened. Use the Drive Screws Provided and Use a small Hammer to Tap the Screws into the End Caps and on the Planks.



NO.	PART NUMBER	DESCRIPTION	MATERIAL	QTY.
1	J2U-SA1	UNIVERSAL ADA TABLE LEG SET		2
2	8IWC-5	1 5/16" OD J2 WC TABLE CROSS BRACE	1 5/16" OD X 14 GAUGE ROUND MECH TUBING	2
3	IPTA-6	CENTER SUPPORT CLEAT WITH STUD	Steel - Galv or Coated after welding	1
4	IA-10	END CAP, 2"x10" PLANK	ALUM EXTRUSION 6063-T6	4
5	IPTA-10	ALUM END CAP	ALUM 1 3/4" PLANK END CAP 6063-T6	2
6	IA-12	PLANK CLIP, 2"x10"	ALUM EXTRUSION 6063-T6	22
7	Regular LW 0.375	LOCK WASHER 3/8"		3
8	HNUT 0.3750-16-D-N	3/8"-16 HEX NUT		2
9	HBOLT 0.3750-16x1x1-N	3/8"-16x 1" HEX HEAD BOLT		2
10	FLATW-3/8	FLAT WASHER 3/8"		3
11	8IA-7	95.875 No End Caps	6063-T6	5
12	DRIVES-3/4	DRIVE SCREW 3/4"		12
13	RHSNBOLT 0.3125-18x1.25x1.25-N	RHSN CARRIAGE BOLT 5/16-18 x 1 1/4"		22
14	NUT-5/16-18 Flanged Nut	KAY-HNUT-.3125 FLANGED		22
15	HNUT 0.3750-16-D-N	HNUT 0.3750-16-D-N	ZINC PLATED STEEL	1

GENERAL NOTES

Built In House

PATH TO PART OR ASSM - S:\CADDRWGS\Solidworks\Tables\J2\New Handicap Table 062016\

DIMENSIONS ARE IN INCHES
TOLERANCES: LINEAR: ± 1/16"
ANGULAR: ± 1°

CONFIDENTIAL DRAWING.
INFORMATION IS NOT TO BE COPIED OR
DISCLOSED TO OTHERS WITHOUT
CONSENT OF KAY INDUSTRIES.
SPECIFICATIONS SUBJECT TO CHANGE
WITHOUT NOTICE.

SHEET SIZE
B

DRAWN BY
APPROVED
LAST SAVED

SCALE
1:24

REV
4/25/2018
davef
3/19/2019



K Industries, Inc.

DESC: 8 FT. UNIVERSAL WHEEL CHAIR TABLE WITH 2"x 10" ANODIZED ALUMINUM TOP AND SEAT PLANKS
MATL:
PART NO: 8J2GA-UWC

Configuration - Default

3/19/2019 11:14:56

SHEET 2 OF 2